

YALIS®

*[Open With Elegance]*

Add: NO.77 Songbai Rd,Hefeng Industrial Area, Xiaolan Town,  
Zhongshan 528415,Guangdong,China

TEL : 0086-760-22255719

FAX : 0086-760-22835718

E-mail:cyx@yalislock.com

Website: www.yalishardware.com

yalis.en.alibaba.com

YALIS DIRTIBUTOR IN VIETNAM:

Nguyen Ha Investment and Development ., LTD

Head Office : R.1406 – CT2 – Văn Khe New Urban – Ha Dong District,Ha Noi ,Viet Nam

Tel : 0439972266 – 04.66636324

Website: www.nguyenhagroup.com.vn



**YALIS®**

**ARCHITECTURAL HARDWARE**

www.yalishardware.com



THANK YOU FOR YOUR  
OPENING THE **YALIS**  
PRODUCT CATALOG.



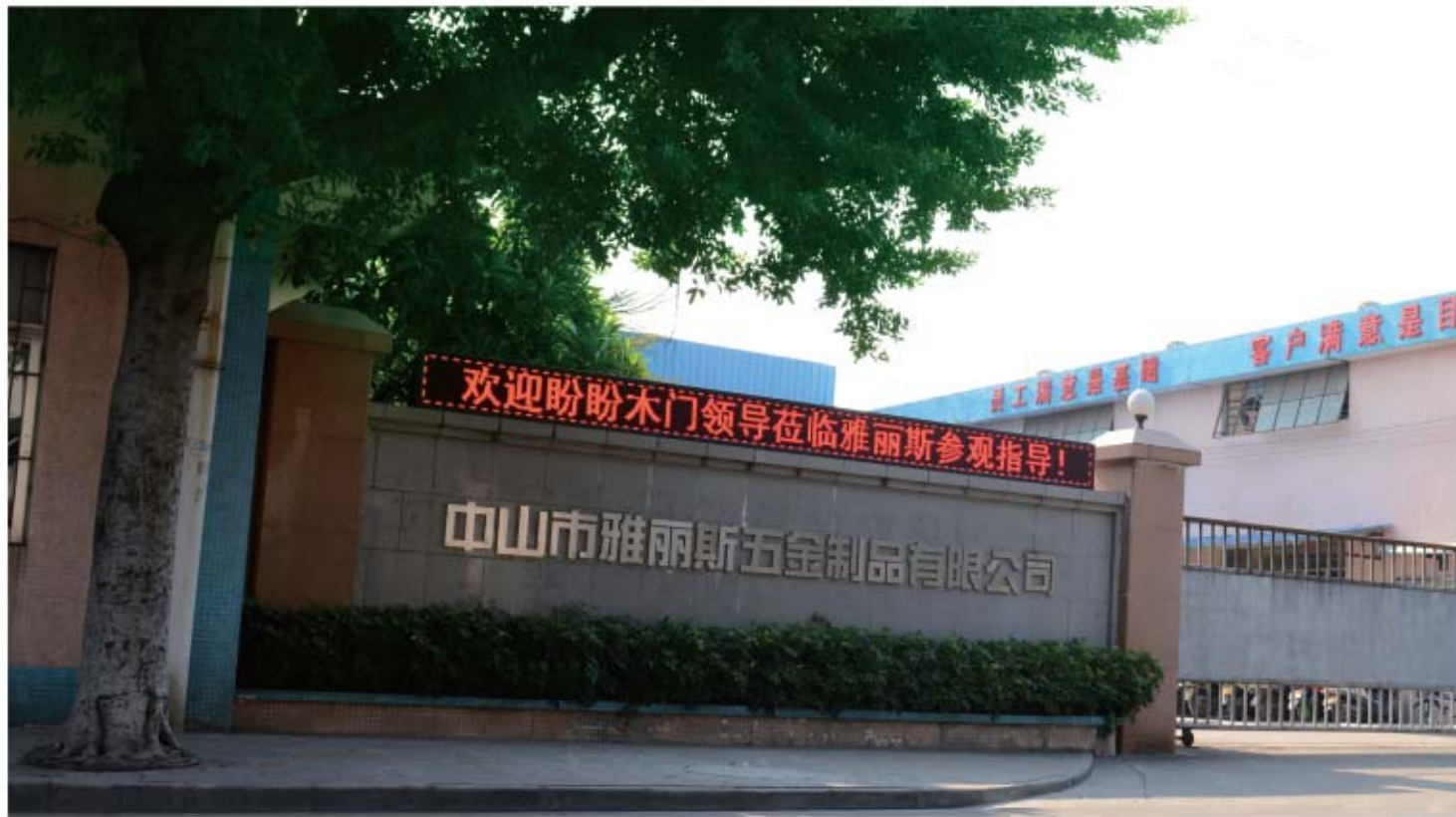

As a visionary and pioneering company in Hardware, was established in 1991 by Mr Lee. With a passion to create something unique, Yalis has created several series of patented products which are very elegant. Moreover, Yalis hardware, locate in XiaoLan Town, where it is generally known as the industrial base of China Hardware.

As 15 years goes by, Yalis has become a brand with security, trust, innovation and integrity. Yalis has accumulate thousand of customers and cooperative partners, making Yalis develop better and better. Yalis' s products are- Door Handles & Pull handles in various metals, Door Locks, Door hinges, and other builder hardware accessories and many more. The Group has also spread its wings into specialized Mechatronic Locking systems, and has introduced its complete range of sanitary and bath fittings.

Yalis hardware, is a company with strong production line, from mold design and produce, die-casting, polishing, and electroplating. And the excellent professional and technical personnel team makes sure the high efficient production. How do we define the strong production line? Yalis owns over 3000 square meters warehouse for meeting the demand from various clients. Due to the huge warehouse, Yalis is able to finish the big order within 35 days. Besides, as for the production workshop, it is also over 3000 square meters, including the mold department, die-casting department, and polishing department.



Yalis adopt high standard electroplating technique (7 layers). Yalis has many finishes to fit different market. In our shining chrome products, Yalis can meet over 300 hours neutral salt spray test (NSS), and over 24 hours CASS test. High standard electroplating technique lead to the high quality. Also, Yalis has a perfect production line from material, diecasting, machining, polishing, electroplating, quality checking, assembling and packaging. Yalis, as a professional manufacturer, we have More than 20 advanced die casting machine, processing equipment and polishing equipment. From product R&D to technology innovation, from work procession to quality inspection, Yalis always insists on innovating technology, continually introducing characteristic door locks, and offering our clients a new high quality life experience.

In the future, Yalis will create more aesthetic products to meet the needs of customers and cooperative partners. That is why we always said: Choosing Yalis, Open door with elegance.

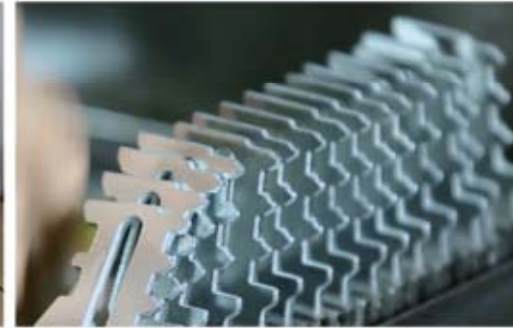

## Die-casting Department

There are 10 sets die-casting machines in Yalis die-casting department, working pressure from 90 tons to 280 tons for different kinds of door locks. Yalis die-casting machines make high quality appearance with no rippling and micro pores. It is no exaggeration to say that Yalis production facility is one of the leader in Zhongshan city, even in China.





### **Quality control, strong QC team**

Each process is strictly controlled by our strong QC team, and gives you high quality Guarantee products make you free of trouble.



**or handle locks**

**10-20**

+

**erance door locks**

**05-09**

**om door locks**

**01-04**

+

**Artise lock and cylinders**  
**43-47**

**or hardware**  
**35-42**

**ular leverset and knobset**  
**31-34**

**ss hardware**  
**21-30**

+

+

## Direction of the handles:

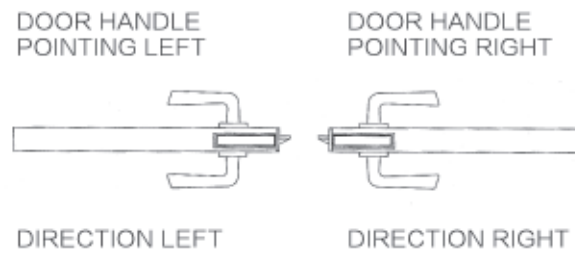

## Standard for opening directions:

When the door is close, people stand outdoor,  
hinge on the left, it is called left.  
hinge on the right, it is called right.

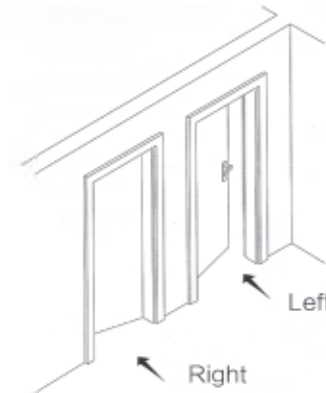
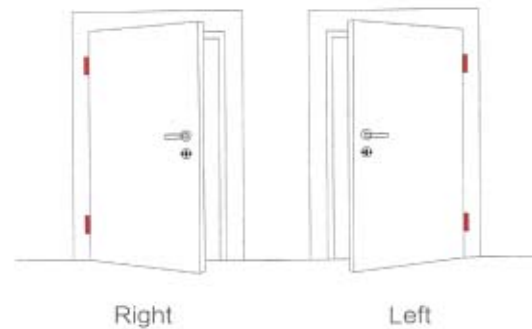

## Door type

Profile of a rebated door with mortise lock (forend protruding on one side).  
Profile of a non-rebated door with mortise lock (forend protrudes on both side).

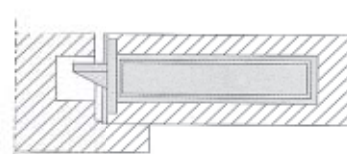
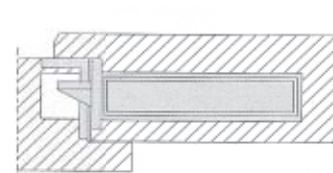

# Installation Diagram:

Installation diagram of lockset with plate

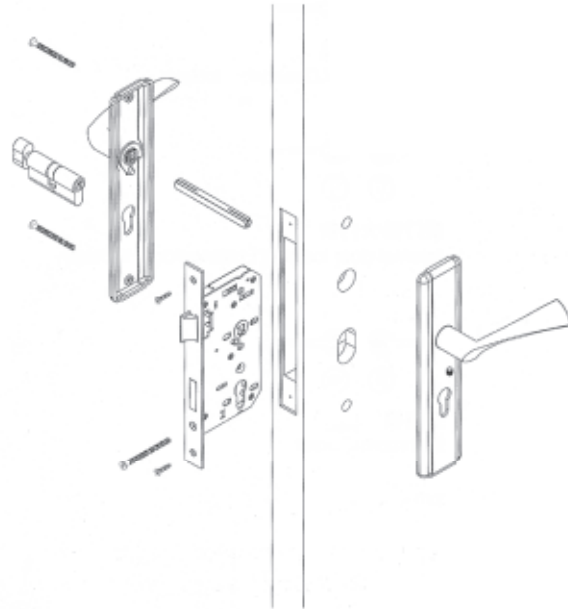

Installation diagram of lockset with rose

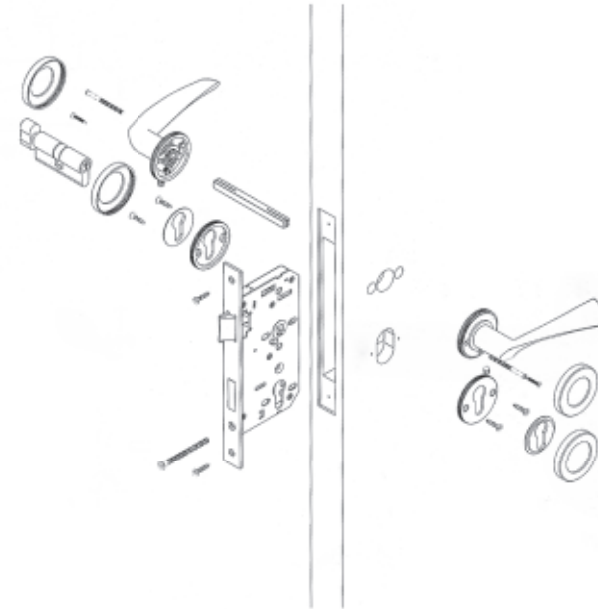

Bathroom lockset installation drawing

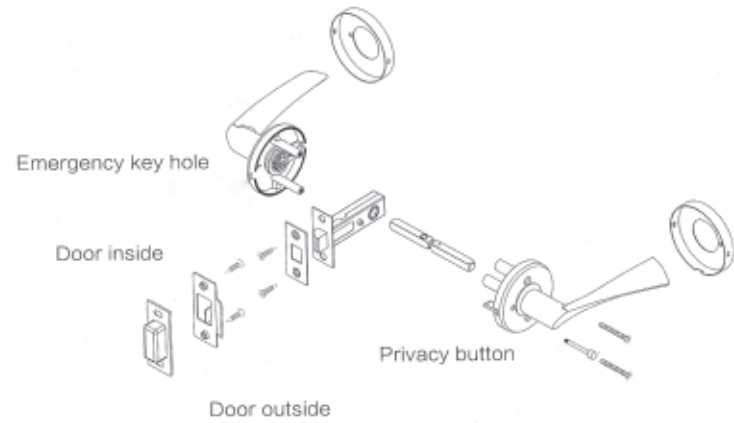

Installation diagram of lockplate

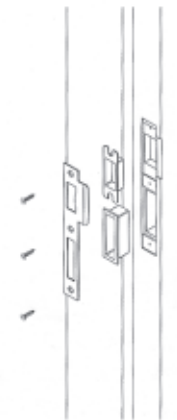

## American Entrance Handleset

American lockset is anti-theft and luxury lockset, which is equipped with large backplate and handle. Mainly apply to the use of large off-type of hotels and villas.

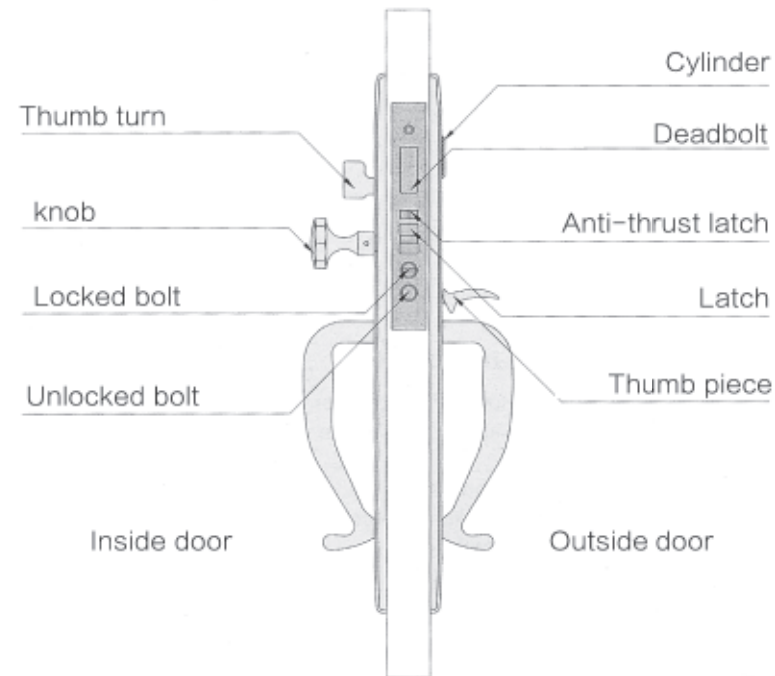

### Functions:

#### Pry function

When the locked bolt is pressed down and the deadbolt is unlocked, the door can't be opened outside by the thumb piece, and need key to open.

#### Anti-thrust function

Locked the door with keys outside or with the thumb turn inside, the deadbolt would be extended and the locked bolt and anti-thrust latch would be press down. At this time, key only outside.

#### Escape function

When the door locked, the deadbolt and the latch can be withdrawn simultaneously by inside handle.

## Installation diagram

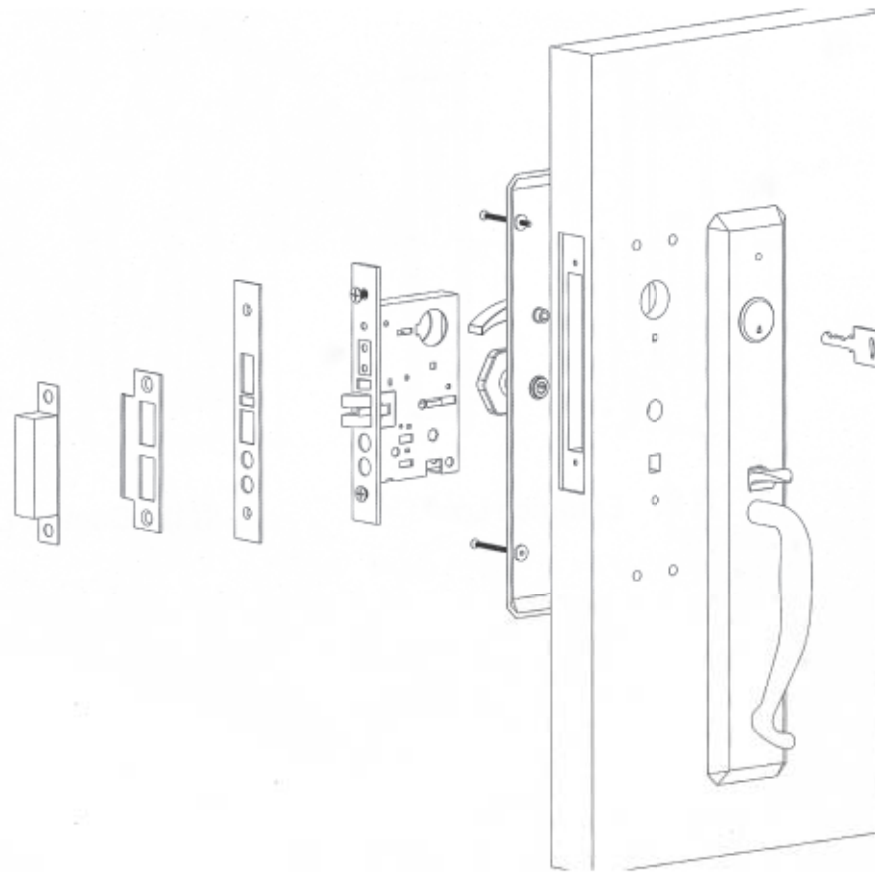

## Lockcase Reversible Direction

Put the lockcase upside down, press the latch into the lockcase by hand when the block fall down naturally. Then use screwdriver to drive back the latch extension unit in order to allow the latch rotated 180 degree and let it reset.



## Category



Euro cylinder

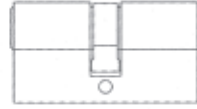

Double cylinder

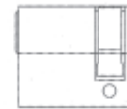

Half cylinder

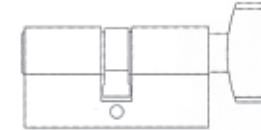

Thumb turn cylinder

## Door leaf thickness

Determination of the cylinder length

The total length of cylinder = door thickness + thickness of the fitting on the outside + thickness of the fitting on the inside

Cylinder is equal side cylinder if it is fitted in the middle of door

Cylinder is unequal side cylinder if it isn't in the middle of door

The cylinder must protrude only max 2 -3mm from the fitting on the outside and inside

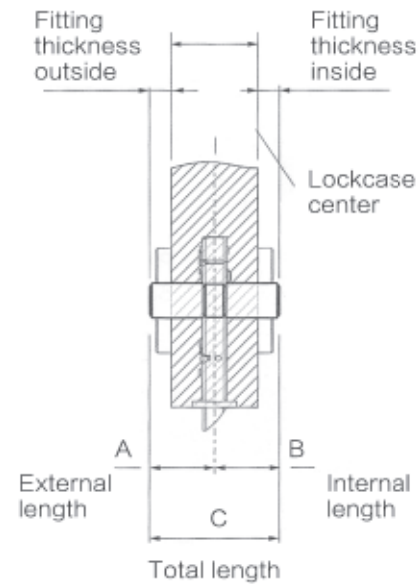

## Master key system

Where one or more locking cylinder are not only operated by an individual key, but also by superior keys, so called master key system is created.

Master key system is usually used for apartment, office building, commercial space, warehouse and so on.

## Grand master key system

Each group of locks is operated by one master key with an overall grand master key.

According to different identity and job title, there are several level of master keys can be set to operate different sets of lock.

Master key system can be settle in different lever as needed.

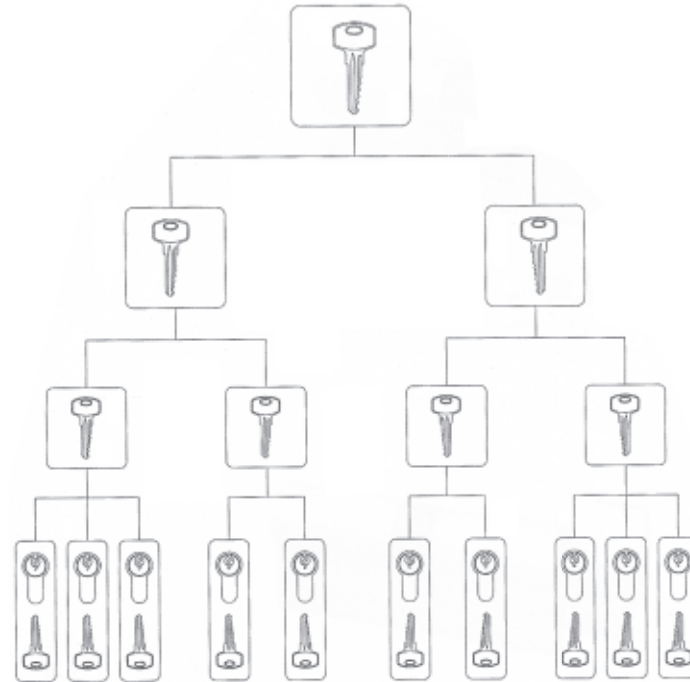

## Key Alike System

In key alike system, a number of lock can be operated by the same key.

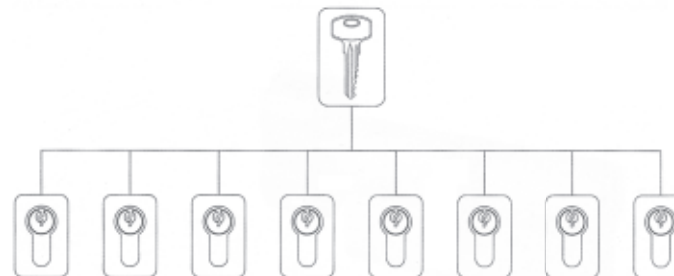



# Home door locks

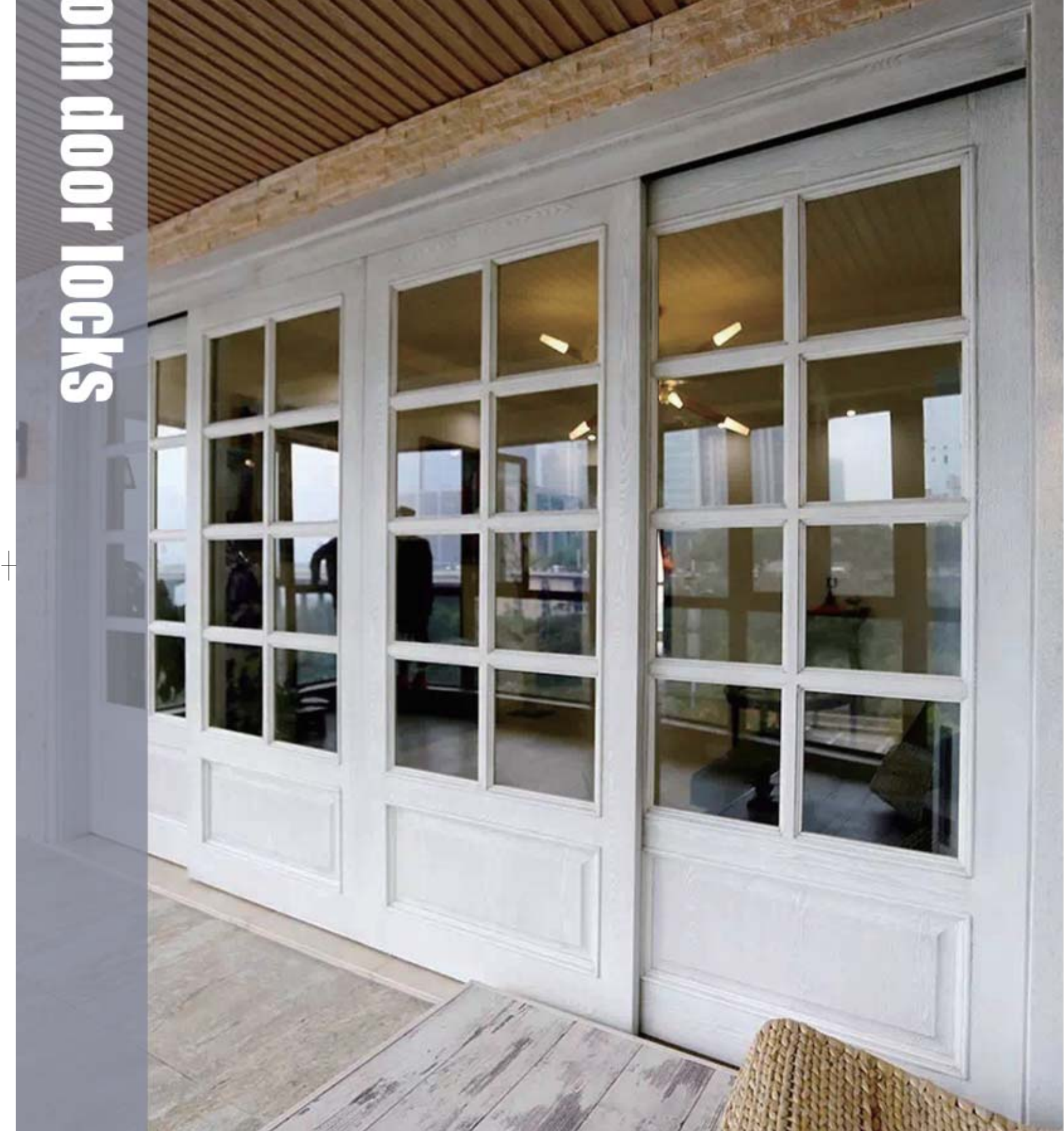

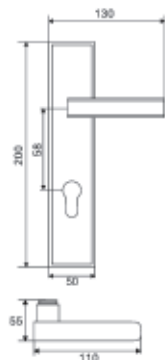

## K8342

Material: Zinc Alloy

Finish: SN/NP

Mortise lock: Euro profile double bolt mortise lock (45\*58mm)

Latch & Bolt: Zinc Alloy

Cylinder: Euro profile solid brass single-open cylinder with 5 computerized keys

Applicable: door thickness 45-55mm or special request

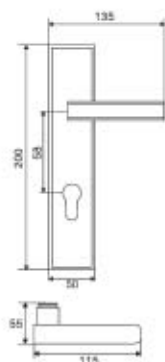

## K8445

Material: Zinc Alloy

Finish: SN/NP

Mortise lock: Euro profile double bolt mortise lock (45\*58mm)

Latch & Bolt: Zinc Alloy

Cylinder: Euro profile solid brass single-open cylinder with 5 computerized keys

Applicable: door thickness 45-55mm or special request

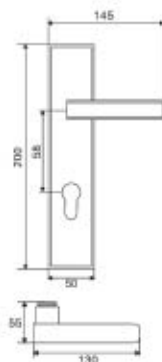

### K8140

Material: Zinc Alloy

Finish: SN/NP

Mortise lock: Euro profile double bolt mortise lock (45\*58mm)

Latch & Bolt: Zinc Alloy

Cylinder: Euro profile solid brass single-open cylinder with 5 computerized keys

Applicable: door thickness 45-55mm or special request



### A9830

Material: Zinc Alloy

Finish: SN/NP

Mortise lock: Euro profile double bolt mortise lock (45\*85mm)

Latch & Bolt: Brass

Cylinder: Euro profile solid brass single-open cylinder with 5 computerized keys

Applicable: door thickness 45-55mm or special request

Available finish: PB

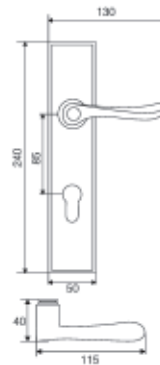

## A9137

Material: Zinc Alloy

Finish: SN/NP

Mortise lock: Euro profile double bolt mortise lock (45\*85mm)

Latch & Bolt: Brass

Cylinder: Euro profile solid brass single-open cylinder with 5 computerized keys

Applicable: door thickness 45-55mm or special request

Available finish: PB

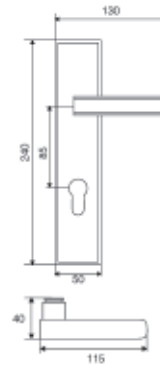

## A9236

Material: Zinc Alloy

Finish: SN/NP

Mortise lock: Euro profile double bolt mortise lock (45\*85mm)

Latch & Bolt: Brass

Cylinder: Euro profile solid brass single-open cylinder with 5 computerized keys

Applicable: door thickness 45-55mm or special request

Available finish: PB

# Entrance door locks





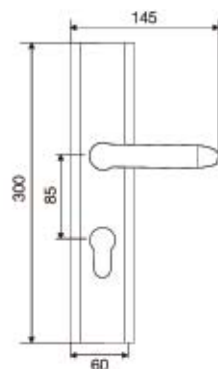

### CS7080

Material: SS304

Finish: SSS

Mortise lock: Euro profile double bolt mortise lock (60\*85mm)

Latch & Bolt: Brass

Cylinder: Euro profile solid brass single-open cylinder with 5 computerized keys

Applicable: door thickness 45-55mm or special request

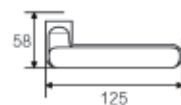
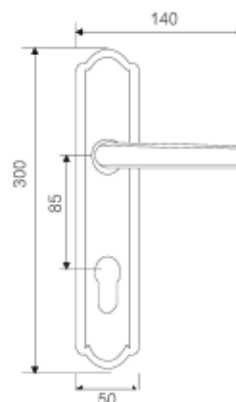

### CS7882

Material: SS304

Finish: SSS

Mortise lock: Euro profile double bolt mortise lock (60\*85mm)

Latch & Bolt: Brass

Cylinder: Euro profile solid brass single-open cylinder with 5 computerized keys

Applicable: door thickness 45-55mm or special request

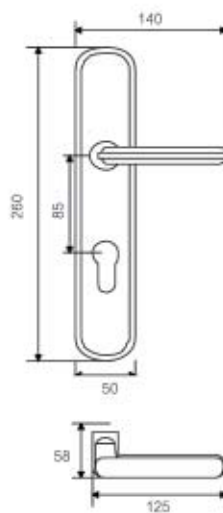

### AS6992

Material: SS304

Finish: SSS

Mortise lock: Euro profile double bolt mortise lock (45\*85mm)

Latch & Bolt: Brass

Cylinder: Euro profile solid brass single-open cylinder with 5 computerized keys

Applicable: door thickness 45-55mm or special request

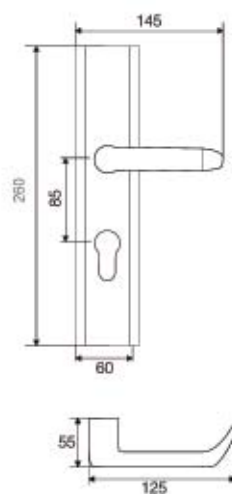

### AS6080

Material: SS304

Finish: SSS

Mortise lock: Euro profile double bolt mortise lock (45\*85mm)

Latch & Bolt: Brass

Cylinder: Euro profile solid brass single-open cylinder with 5 computerized keys

Applicable: door thickness 45-55mm or special request





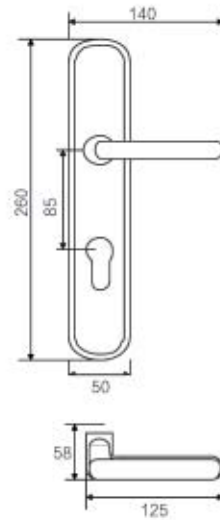

### AS6887

Material: SS304

Finish: SSS

Mortise lock: Euro profile double bolt mortise lock (45\*85mm)

Latch & Bolt: Brass

Cylinder: Euro profile solid brass single-open cylinder with 5 computerized keys

Applicable: door thickness 45-55mm or special request

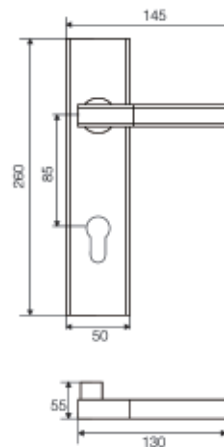

### AS6085

Material: SS304

Finish: SSS

Mortise lock: Euro profile double bolt mortise lock (45\*85mm)

Latch & Bolt: Brass

Cylinder: Euro profile solid brass single-open cylinder with 5 computerized keys

Applicable: door thickness 45-55mm or special request

# Door handle locks



+

+

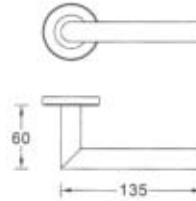

### BFS7095

Material: SS304

Finish: SSS

Mortise lock: Euro profile double bolt mortise lock (60\*85mm)

Latch & Bolt: Brass

Cylinder: Euro profile solid brass single-open cylinder with 5 computerized keys

Applicable: door thickness 45-55mm or special request

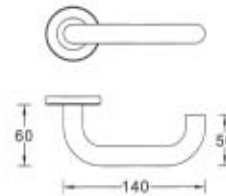

### BFS7091

Material: SS304

Finish: SSS

Mortise lock: Euro profile double bolt mortise lock (60\*85mm)

Latch & Bolt: Brass

Cylinder: Euro profile solid brass single-open cylinder with 5 computerized keys

Applicable: door thickness 45-55mm or special request



### BFS70311

Material: SS304

Finish: SSS

Mortise lock: Euro profile double bolt mortise lock (60\*85mm)

Latch & Bolt: Brass

Cylinder: Euro profile solid brass single-open cylinder with 5 computerized keys

Applicable: door thickness 45-55mm or special request

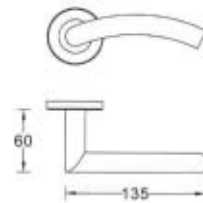

### BFS70312

Material: SS304

Finish: SSS

Mortise lock: Euro profile double bolt mortise lock (60\*85mm)

Latch & Bolt: Brass

Cylinder: Euro profile solid brass single-open cylinder with 5 computerized keys

Applicable: door thickness 45-55mm or special request

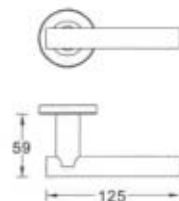

### BFS70307

Material: SS304

Finish: SSS

Mortise lock: Euro profile double bolt mortise lock (60\*85mm)

Latch & Bolt: Brass

Cylinder: Euro profile solid brass single-open cylinder with 5 computerized keys

Applicable: door thickness 45-55mm or special request

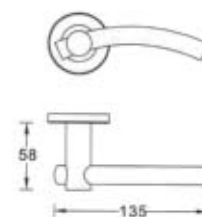

### BFS70304

Material: SS304

Finish: SSS

Mortise lock: Euro profile double bolt mortise lock (60\*85mm)

Latch & Bolt: Brass

Cylinder: Euro profile solid brass single-open cylinder with 5 computerized keys

Applicable: door thickness 45-55mm or special request

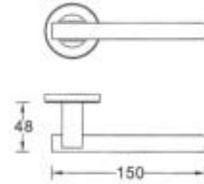

### BFS70305

Material: SS304

Finish: SSS

Mortise lock: Euro profile double bolt mortise lock (60\*85mm)

Latch & Bolt: Brass

Cylinder: Euro profile solid brass single-open cylinder with 5 computerized keys

Applicable: door thickness 45-55mm or special request

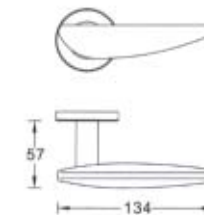

### BFS70306

Material: SS304

Finish: SSS

Mortise lock: Euro profile double bolt mortise lock (60\*85mm)

Latch & Bolt: Brass

Cylinder: Euro profile solid brass single-open cylinder with 5 computerized keys

Applicable: door thickness 45-55mm or special request

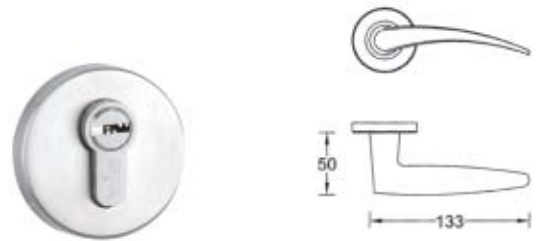

### BFS70310

Material: SS304

Finish: SSS

Mortise lock: Euro profile double bolt mortise lock (60\*85mm)

Latch & Bolt: Brass

Cylinder: Euro profile solid brass single-open cylinder with 5 computerized keys

Applicable: door thickness 45-55mm or special request

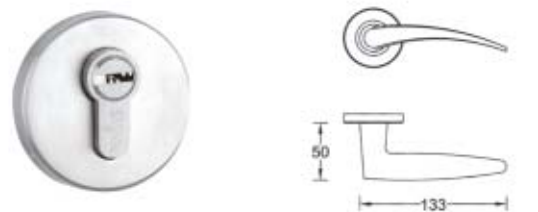

### BFS70301

Material: SS304

Finish: SSS

Mortise lock: Euro profile double bolt mortise lock (60\*85mm)

Latch & Bolt: Brass

Cylinder: Euro profile solid brass single-open cylinder with 5 computerized keys

Applicable: door thickness 45-55mm or special request

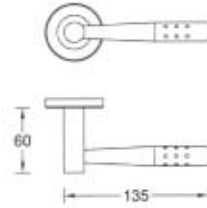

### BFS70303

Material: SS304

Finish: SSS

Mortise lock: Euro profile double bolt mortise lock (60\*85mm)

Latch & Bolt: Brass

Cylinder: Euro profile solid brass single-open cylinder with 5 computerized keys

Applicable: door thickness 45-55mm or special request

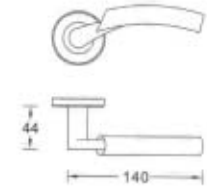

### BFS7084

Material: SS304

Finish: SSS

Mortise lock: Euro profile double bolt mortise lock (60\*85mm)

Latch & Bolt: Brass

Cylinder: Euro profile solid brass single-open cylinder with 5 computerized keys

Applicable: door thickness 45-55mm or special request





### BF70302

Material: Zinc Alloy

Finish: Polished Chrome

Mortise lock: Euro profile double bolt mortise lock (60\*85mm)

Latch & Bolt: Brass

Cylinder: Euro profile solid brass single-open cylinder with 5 computerized keys

Applicable: door thickness 45-55mm or special request

Available finish: GP BLK



### BF74204

Material: Zinc Alloy

Finish: Polished Chrome

Mortise lock: Euro profile double bolt mortise lock (60\*85mm)

Latch & Bolt: Brass

Cylinder: Euro profile solid brass single-open cylinder with 5 computerized keys

Applicable: door thickness 45-55mm or special request

Available finish: GP BLK



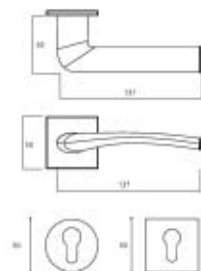

### BF79205

Material: Zinc Alloy

Finish: Polished Chrome

Mortise lock: Euro profile double bolt mortise lock (60\*85mm)

Latch & Bolt: Brass

Cylinder: Euro profile solid brass single-open cylinder with 5 computerized keys

Applicable: door thickness 45-55mm or special request

Available finish: GP BLK

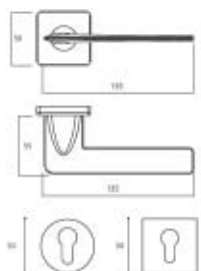

### BF79206

Material: Zinc Alloy

Finish: Polished Chrome

Mortise lock: Euro profile double bolt mortise lock (60\*85mm)

Latch & Bolt: Brass

Cylinder: Euro profile solid brass single-open cylinder with 5 computerized keys

Applicable: door thickness 45-55mm or special request

Available finish: GP BLK



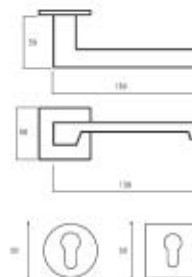

### BF79207

Material: Zinc Alloy

Finish: Polished Chrome

Mortise lock: Euro profile double bolt mortise lock (60\*85mm)

Latch & Bolt: Brass

Cylinder: Euro profile solid brass single-open cylinder with 5 computerized keys

Applicable: door thickness 45-55mm or special request

Available finish: GP BLK

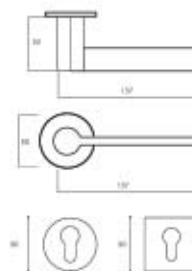

### BF74208

Material: Zinc Alloy

Finish: Polished Chrome

Mortise lock: Euro profile double bolt mortise lock (60\*85mm)

Latch & Bolt: Brass

Cylinder: Euro profile solid brass single-open cylinder with 5 computerized keys

Applicable: door thickness 45-55mm or special request

Available finish: GP BLK



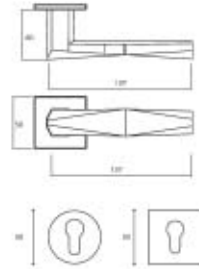

### BF79209

Material: Zinc Alloy

Finish: Polished Chrome

Mortise lock: Euro profile double bolt mortise lock (60\*85mm)

Latch & Bolt: Brass

Cylinder: Euro profile solid brass single-open cylinder with 5 computerized keys

Applicable: door thickness 45-55mm or special request

Available finish: GP BLK

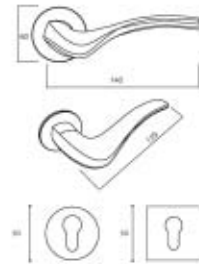

### BF74210

Material: Zinc Alloy

Finish: Polished Chrome

Mortise lock: Euro profile double bolt mortise lock (60\*85mm)

Latch & Bolt: Brass

Cylinder: Euro profile solid brass single-open cylinder with 5 computerized keys

Applicable: door thickness 45-55mm or special request

Available finish: GP BLK



# SS hardware



+

+



### TTBL1818

Material: Brass

Finish: Rose Gold

Mortise lock: Stainless Steel American lock body (64\*87mm)

Bolt & Latch: Brass

Cylinder: American standard cylinder with master keys and construction keys

Application: door thickness 45-55mm or special request

Available finish: RG, CB, AB

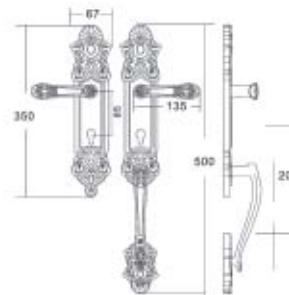

### PB1818

Material: Brass

Finish: Rose Gold

Mortise lock: Euro profile double bolt mortise lock (60\*85mm)

Bolt & Latch: Brass

Cylinder: Euro profile solid brass single-open cylinder with 5 computerized keys

Applicable: door thickness 45-55mm or special request

Available finish: RG, CB, AB



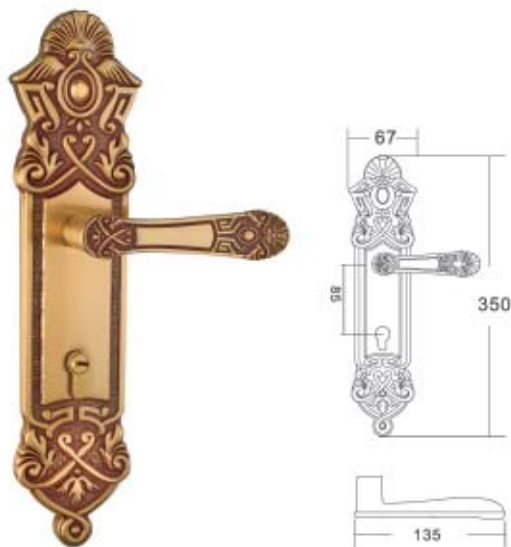

### CB1818

Material: Brass

Finish: Rose Gold

Mortise lock: Euro profile double bolt mortise lock (60\*85mm)

Cylinder: Euro profile cylinder with 5 computerized keys

Applicable: door thickness 45-55mm or special request

Available finish: RG, CB, AB

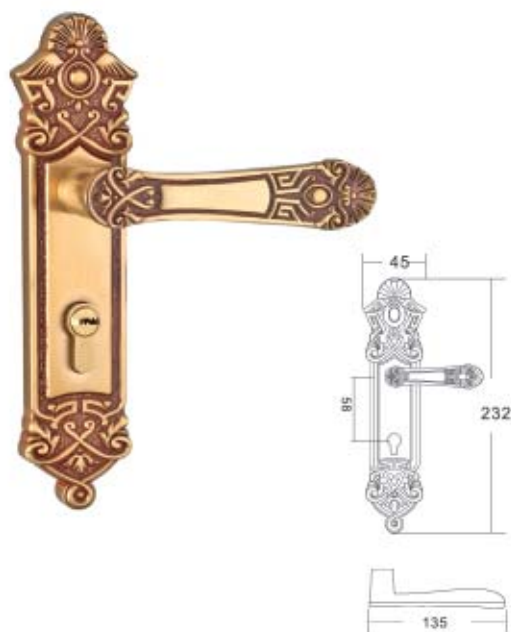

### LB1818

Material: Brass

Finish: Rose Gold

Mortise lock: Euro profile double bolt mortise lock (50\*58mm)

Cylinder: Euro profile solid brass single-open cylinder with 5 computerized keys

Applicable: door thickness 45-55mm or special request

Available finish: RG, CB, AB





### BF1818

Material: Brass  
 Finish: Rose Gold  
 Mortise lock: Euro profile double bolt mortise lock (60\*85mm)  
 Bolt & Latch: Brass  
 Cylinder: Euro profile solid brass single-open cylinder with 5 computerized keys  
 Applicable: door thickness 45-55mm or special request  
 Available finish: RG, CB, AB

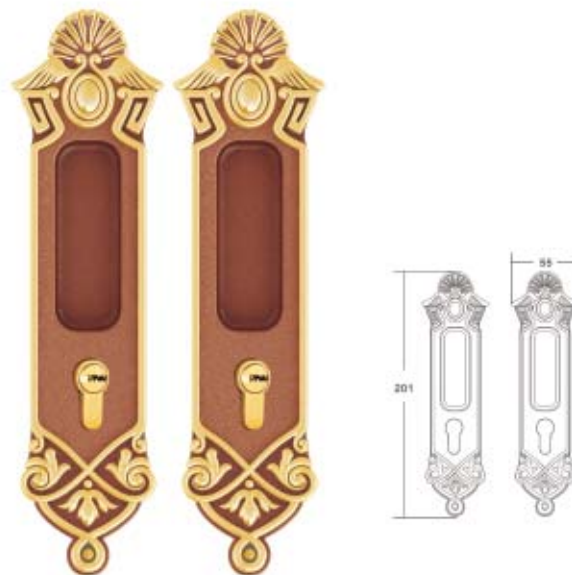

### F1818

Material: Brass  
 Finish: Rose Gold  
 Mortise lock: Euro profile sliding door lock body  
 Backset: 50mm  
 Cylinder: Euro profile solid brass single-open cylinder with 5 computerized keys  
 Applicable: door thickness 45-55mm or special request  
 Available finish: RG, CB, AB







### 1818 Hinge

Material: Brass  
Finish: Rose Gold  
4 Ball Bearing  
Size: 5" x 4" x 4mm  
Available finish: RG, CB, AB

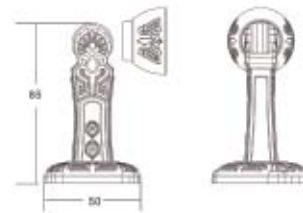

### 1818 Door Stopper

Material: Brass  
Finish: Rose Gold  
Size: 50mm x 85mm  
Available finish: RG, CB, AB





### TTBL2424

Material: Brass

Finish: Rose Gold

Mortise lock: Euro profile double bolt mortise lock (60\*85mm)

Cylinder: Euro profile cylinder with 5 computerized keys

Applicable: door thickness 45-55mm or special request

Available finish: RG, CB, AB

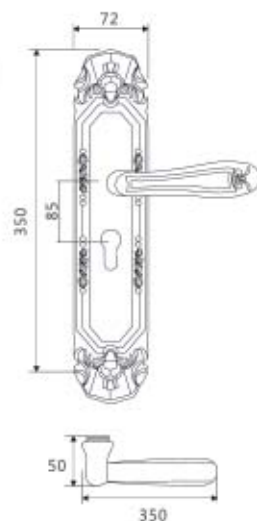

### CB2424

Material: Brass

Finish: Rose Gold

Mortise lock: Euro profile double bolt mortise lock (60\*85mm)

Cylinder: Euro profile cylinder with 5 computerized keys

Applicable: door thickness 45-55mm or special request

Available finish: RG, CB, AB

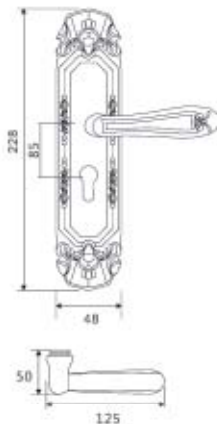
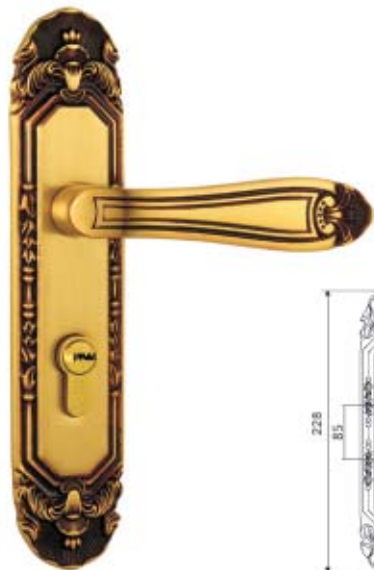

### LB2424

Material: Brass

Finish: Rose Gold

Mortise lock: Euro profile double bolt mortise lock (50\*58mm)

Cylinder: Euro profile cylinder with 5 computerized keys

Applicable: door thickness 45-55mm or special request

Available finish: RG, CB, AB

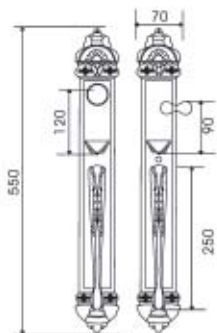

### TTBL2020

Material: Brass

Finish: Rose Gold

Mortise lock: Stainless Steel American lock body (64\*87mm)

Cylinder: American standard cylinder with master keys and construction keys

Application: door thickness 45-55mm or special request

Available finish: RG, CB, AB

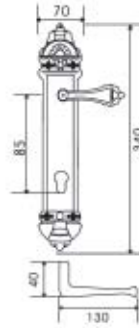

## CB2020

Material: Brass

Finish: Rose Gold

Mortise lock: Euro profile double bolt mortise lock (60\*85mm)

Cylinder: Euro profile cylinder with 5 computerized keys

Applicable: door thickness 45-55mm or special request

Available finish: RG, CB, AB

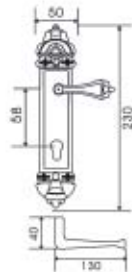

## LB2020

Material: Brass

Finish: Rose Gold

Mortise lock: Euro profile double bolt mortise lock (50\*58mm)

Cylinder: Euro profile cylinder with 5 computerized keys

Applicable: door thickness 45-55mm or special request

Available finish: RG, CB, AB

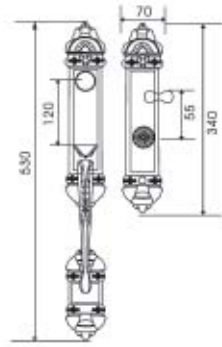

### PB2020

Material: Brass

Finish: Rose Gold

Mortise lock: Euro profile double bolt mortise lock (60\*85mm)

Cylinder: Euro profile cylinder with 5 computerized keys

Applicable: door thickness 45-55mm or special request

Available finish: RG, CB, AB



### LB3595

Material: Brass

Finish: Rose Gold

Mortise lock: Euro profile double bolt mortise lock (50\*58mm)

Cylinder: Euro profile cylinder with 5 computerized keys

Applicable: door thickness 45-55mm or special request

Available finish: RG, CB, AB



**106 Door Hinge**  
 Material: Brass  
 Finish: Rose Gold  
 4 Ball Bearing  
 Size: 4" x 3" x 4mm  
 Available finish: RG, CB, AB

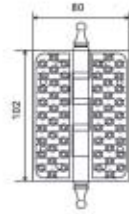

**107 Door Hinge**  
 Material: Brass  
 Finish: Rose Gold  
 4 Ball Bearing  
 Size: 5" x 3.5" x 4mm  
 Available finish: RG, CB, AB

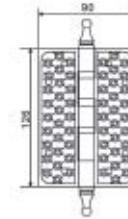

**108 Door Hinge**  
 Material: Brass  
 Finish: Yellow Bronze  
 4 Ball Bearing  
 Size: 4" x 3" x 4mm  
 Available finish: RG, CB, AB

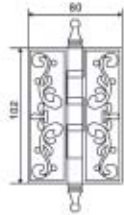

**109 Door Hinge**  
 Material: Brass  
 Finish: Yellow Bronze  
 4 Ball Bearing  
 Size: 5" x 3.5" x 4mm  
 Available finish: RG, CB, AB

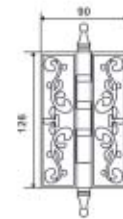

**102 Door Stopper**  
 Material: Brass  
 Finish: Rose Gold  
 Size: 60mm x 90mm  
 Available finish: RG, CB, AB

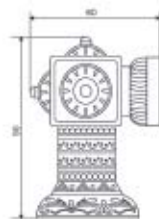

**104 Door Stopper**  
 Material: Brass  
 Finish: Rose Gold  
 Size: 57mm x 95mm  
 Available Finish: RG, CB, AB

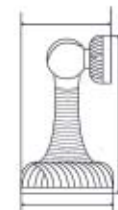

# Popular leverset and knobset

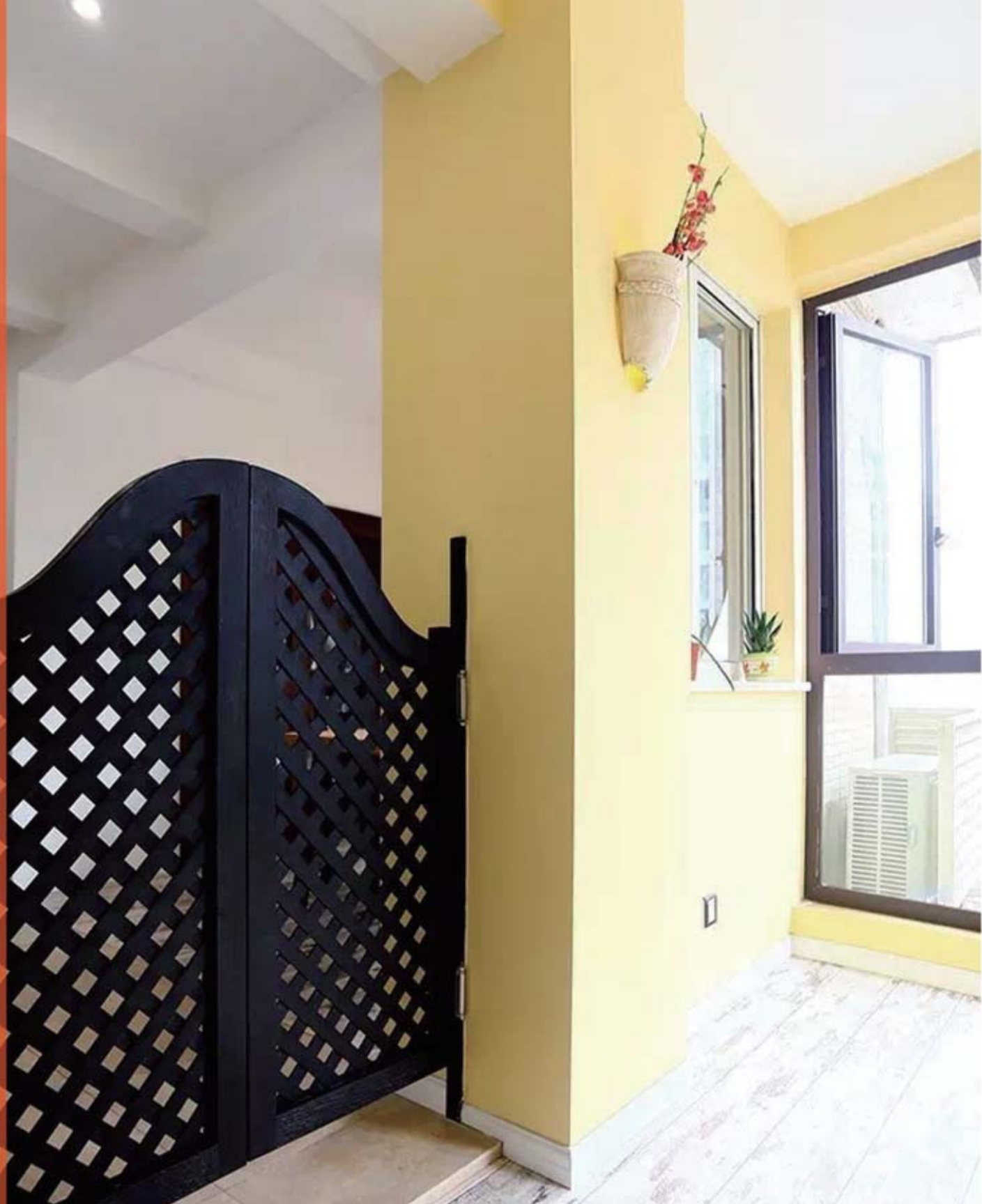

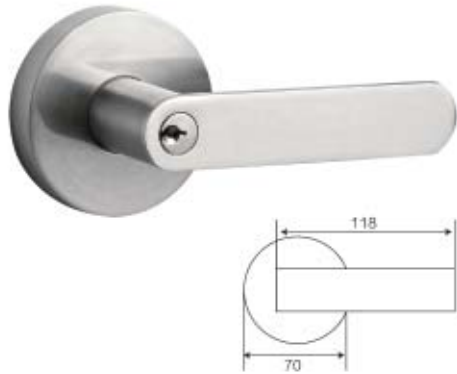

### D102

Material: Zinc alloy

Available Finish: Satin Nickel

Key and cylinder: Normal brass key and solid brass cylinder

Available Function: Keyed/ Dummy/ Privacy/ Passage

Cycle Test: 100,000 times (heavy duty)

Backset: 60mm (2-3/8") or 70mm (2-3/4") adjustable



### D103

Material: Zinc alloy

Available Finish: Satin Nickel

Key and cylinder: Normal brass key and solid brass cylinder

Available Function: Keyed/ Dummy/ Privacy/ Passage

Cycle Test: 100,000 times (heavy duty)

Backset: 60mm (2-3/8") or 70mm (2-3/4") adjustable

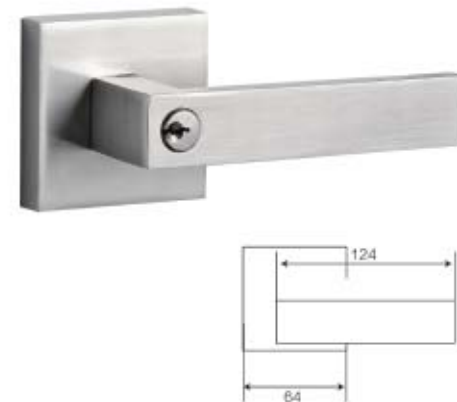

### D104

Material: Zinc alloy

Available Finish: Satin Nickel

Key and cylinder: Normal brass key and solid brass cylinder

Available Function: Keyed/ Dummy/ Privacy/ Passage

Cycle Test: 100,000 times (heavy duty)

Backset: 60mm (2-3/8") or 70mm (2-3/4") adjustable



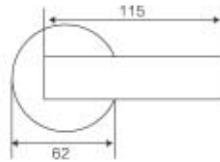

### D105

Material: SS201 (rosette) and Zinc alloy (handle)

Available Finish: Satin Nickel

Key and cylinder: Normal brass key and solid brass cylinder

Available Function: Keyed/ Dummy/ Privacy/ Passage

Backset: 60mm (2-3/8") or 70mm (2-3/4") adjustable

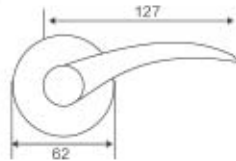

### D106

Material: SS201 (rosette) and Zinc alloy (handle)

Available Finish: Satin Nickel

Key and cylinder: Normal brass key and solid brass cylinder

Available Function: Keyed/ Dummy/ Privacy/ Passage

Backset: 60mm (2-3/8") or 70mm (2-3/4") adjustable

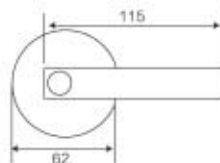

### D107

Material: SS201 (rosette) and Zinc alloy (handle)

Available Finish: Satin Nickel

Key and cylinder: Normal brass key and solid brass cylinder

Available Function: Keyed/ Dummy/ Privacy/ Passage

Backset: 60mm (2-3/8") or 70mm (2-3/4") adjustable



### D109

Material: SS201 (rosette) and Zinc alloy (handle)

Available Finish: Satin Nickel

Key and cylinder: Normal brass key and solid brass cylinder

Available Function: Keyed/ Dummy/ Privacy/ Passage

Backset: 60mm (2-3/8") or 70mm (2-3/4") adjustable



### D5791

Material: SS304

Finish: Satin Stainless Steel

Key and cylinder: Normal brass key and solid brass cylinder

Available Function: Keyed/ Dummy/ Privacy/ Passage

Total weight: 600g

Cycle Test: 100,000 times (heavy duty)

Backset: 60mm (2-3/8") or 70mm (2-3/4")

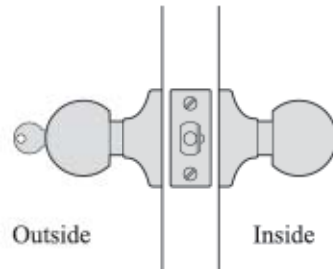
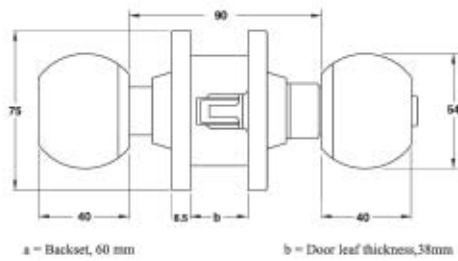

Striking plate

Latch

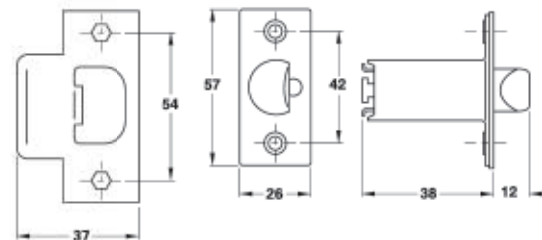

# or hardware



+

+

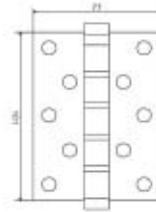

### 4x3x3mm Stainless Steel Butt Hinge

Material: Stainless Steel 304  
 Size: 4" \*3" \*3mm,  $\phi$  14.2mm  
 Ball bearing: 4BB  
 Available: SSS, AB, BLK, AC, PB

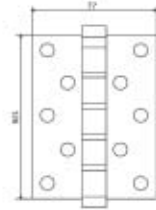

### 5x3x3mm Stainless Steel Butt Hinge

Material: Stainless Steel 304  
 Size: 5" \*3" \*3mm,  $\phi$  14.2mm  
 Ball bearing: 4BB  
 Available: SSS, AB, BLK, AC, PB



Quantity of hinges based on the door height

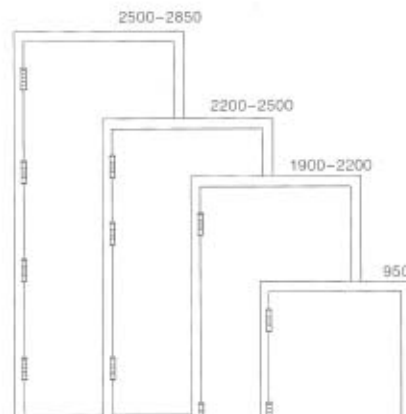

Position of hinges and other ironmongeries

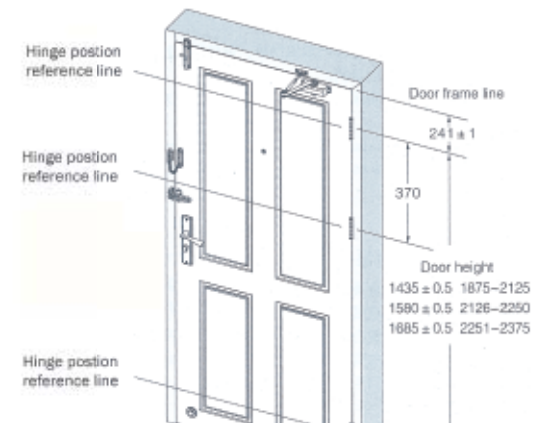

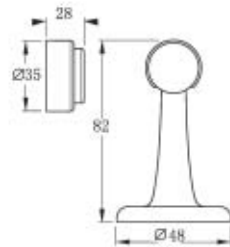

### 901 Door stopper

Material: SS304

Installation on the floor

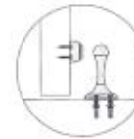
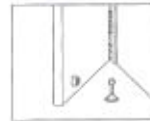

Installation on the wall

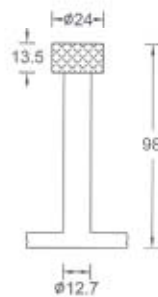
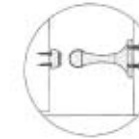

### 911 Door stopper

Material: SS304

Installation on the floor

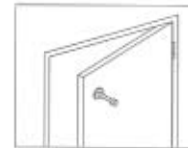

Installation on the wall

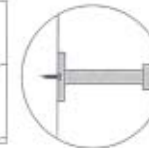
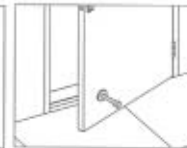

### 912 Door stopper

Material: SS304

Installation on the floor

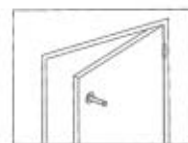

Installation on the wall

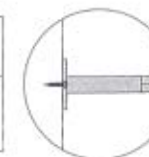
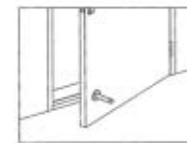



### 913 Door stopper with hook

Material: SS304

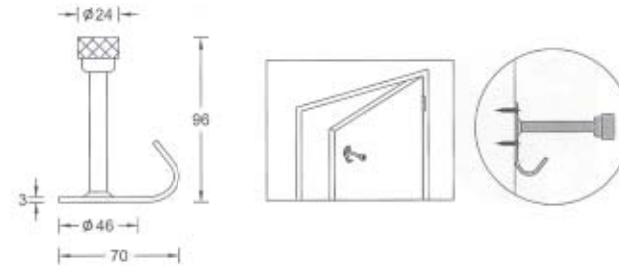

### 914 Dust proof

Material: SS304

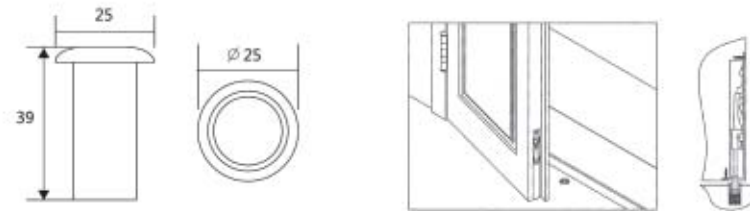

### 915 Floor stopper

Material: SS304

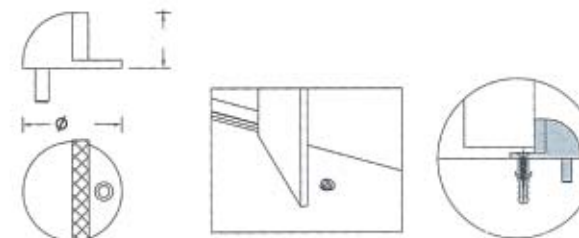



### 602 Door viewer

Material: Brass  
Glass lens  
Degree: 200 degree  
Distance: D1: 30mm, 2: 16mm

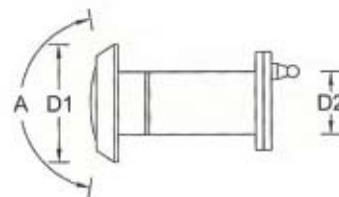

### 605 Door Chain

Material: Zinc alloy

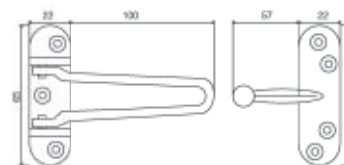

### 606 Security Chain

Material: Zinc alloy

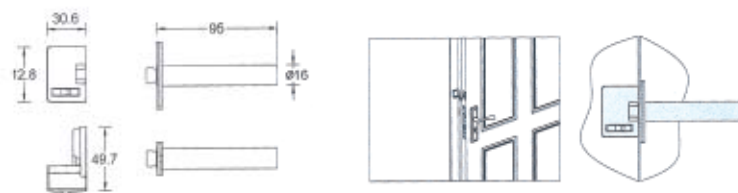



### 609 Tower Bolt

Material: SS304

Length: 8 inch or 6 inch (Special size, please check with us)

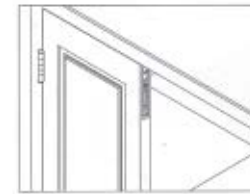
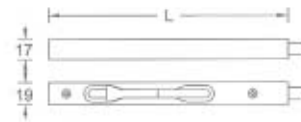

### 608 Door Bolt

Material: SS304

Size: 6" ,8" ,10" ,12"

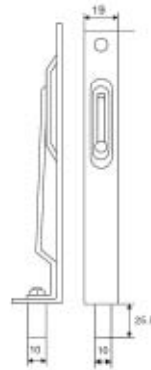

### 701 Door Closer

Material: Aluminium

Finish: Silver

Capacity: 45-65kg

Cycle test: heavy duty(350,000-500,000 times)

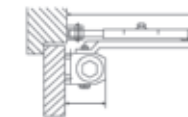
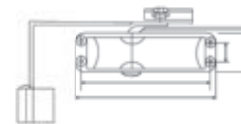





### 705 Concealed Door Closer

Conceal door closer, hold open .  
 powder coating silver finish, size 3 (60kg)  
 Cycle test: heavy duty(350,000-500,000 times)

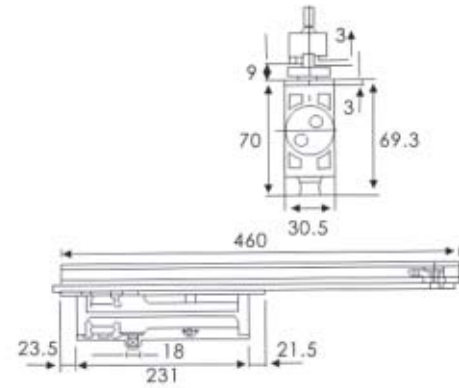

### 706 Concealed Door Closer

Conceal Door closer for door >90kg. Size 4.  
 Steel powder coating, silver.  
 Cycle test: heavy duty(350,000-500,000 times)

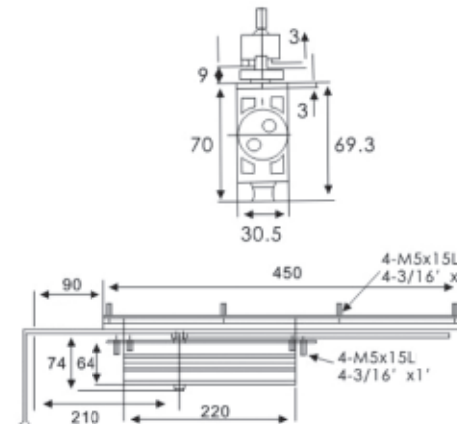



### Panic Bar

Panic bar for single door, SS 304 matt

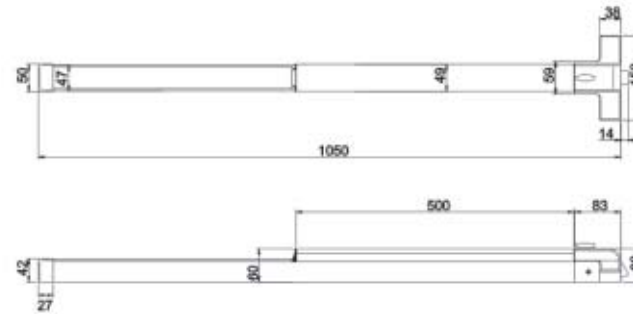

### Panic Bar Handle

Outside lever handle for panic device, Zinc alloy

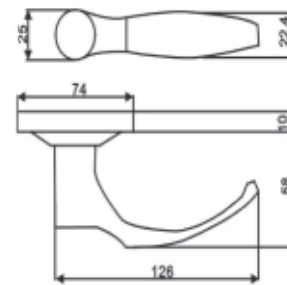

# Artise lock and cylinders

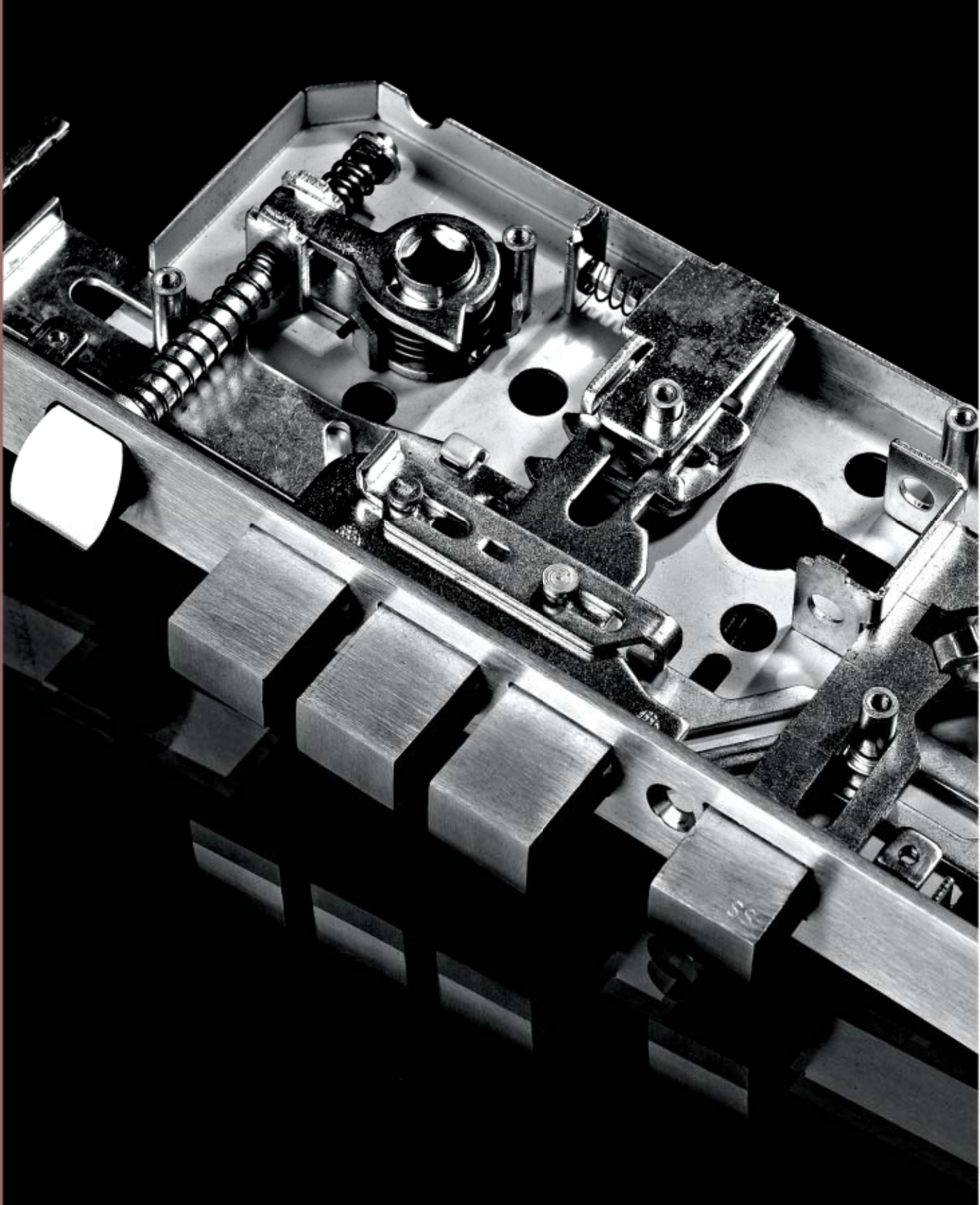



## 64\*87mm Stainless Steel American Standard Mortise Lock

Material: SS304 or brass

Available for: Wooden doors/ Metal doors

Center distance: 87mm

Backset: 64mm

Standard: A156.13-2005

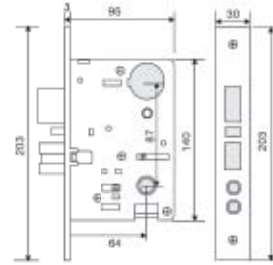

## Euro Profile Double Bolt Mortise Lock

Material: brass

Available for: Wooden doors/ Metal doors

Center distance: 85mm

Backset: 60 or 45mm

Standard: EN12209-2003

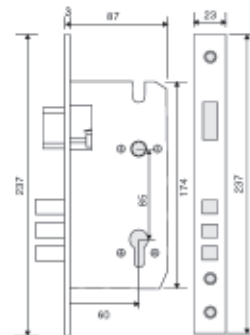



### Euro Profile Double Bolt Mortise Lock

Material: Zinc alloy or brass

Available for: Wooden doors/ Metal doors

Center distance: 58mm

Backset: 45 or 50mm

Standard: EN12209-2003

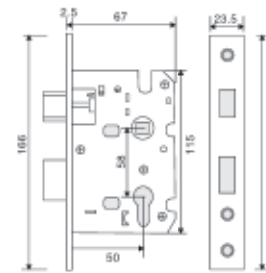

### 50mm Passage Latch

Material: SS/ Cold Rolled Steel

Available for: Room doors/ passage doors

Backset: 50mm

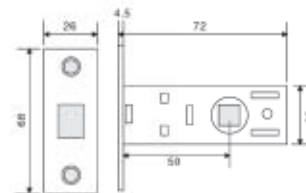

### 60mm Privacy Latch

Material: SS/ Cold Rolled Steel

Available for: Room doors/ bathroom doors

Backset: 60mm

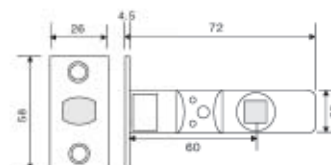

## Euro Profile Cylinder with Computerized Keys

Material: Solid Brass

Type: Key to Knob (Single-open), 7 pins

Key: 2.5mm thickness computerized keys

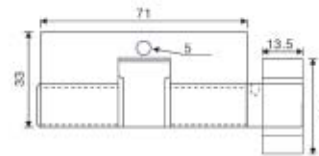

## Euro Profile Cylinder with Computerized Keys

Material: Solid Brass

Type: Key to Key (Double-open), 7 pins

Key: 2.5mm thickness computerized keys

